

# SID Management: CARES Act Data Collection

2020-2021 SY

- *NJ SMART*

# NJ SMART Webinar Etiquette

We want to ensure that all attendees connected to the call can easily hear the training and that all questions are answered.

Lines are muted upon entry:

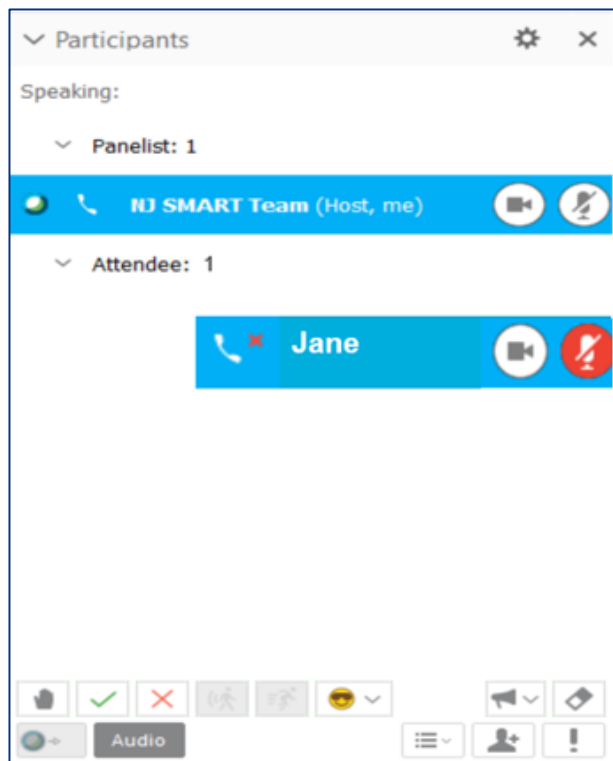

How can I ask a question?

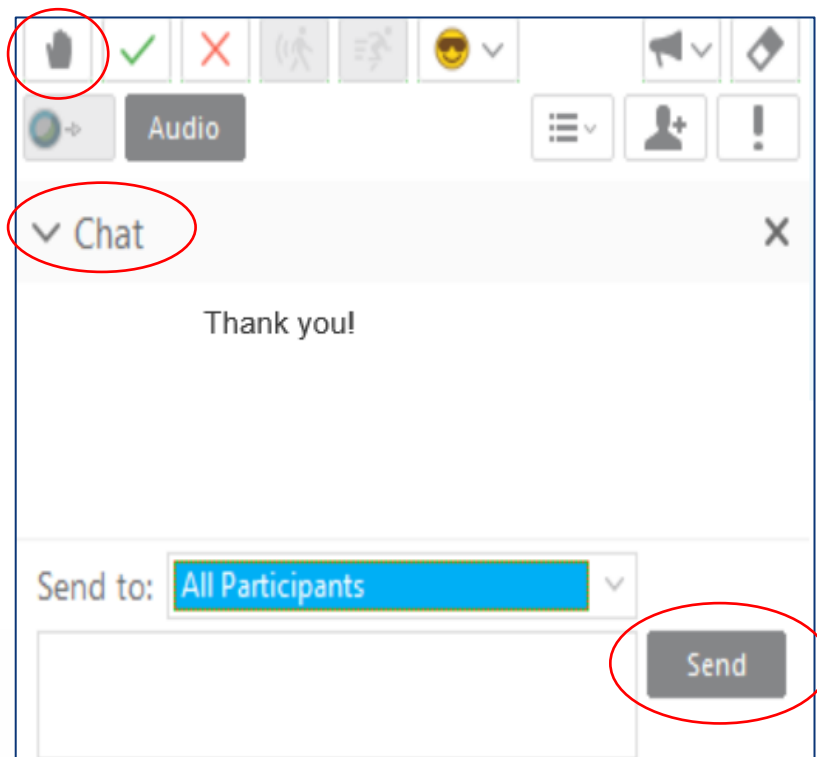

# SID Management: CARES Act Data Collection Agenda

## Introduction

- Find resources to help you get started
- Learn important Dates and Deadlines

## Remote and Hybrid Learning Reporting

- Review the new CARES Act data elements
- How and when to report this data
- Frequently asked questions

## Q&A

- Open forum for questions



# Available Resources

## NJ SMART Helpdesk



1-800-254-0295  
[njsmart@pcgus.com](mailto:njsmart@pcgus.com)

## Resources & Trainings



[NJ SMART Resources & Trainings](#)

# Important Dates and Deadlines:

The new data elements regarding remote and hybrid learning for CARES Act will be collected in SID Management on November 24<sup>th</sup> at 5pm.

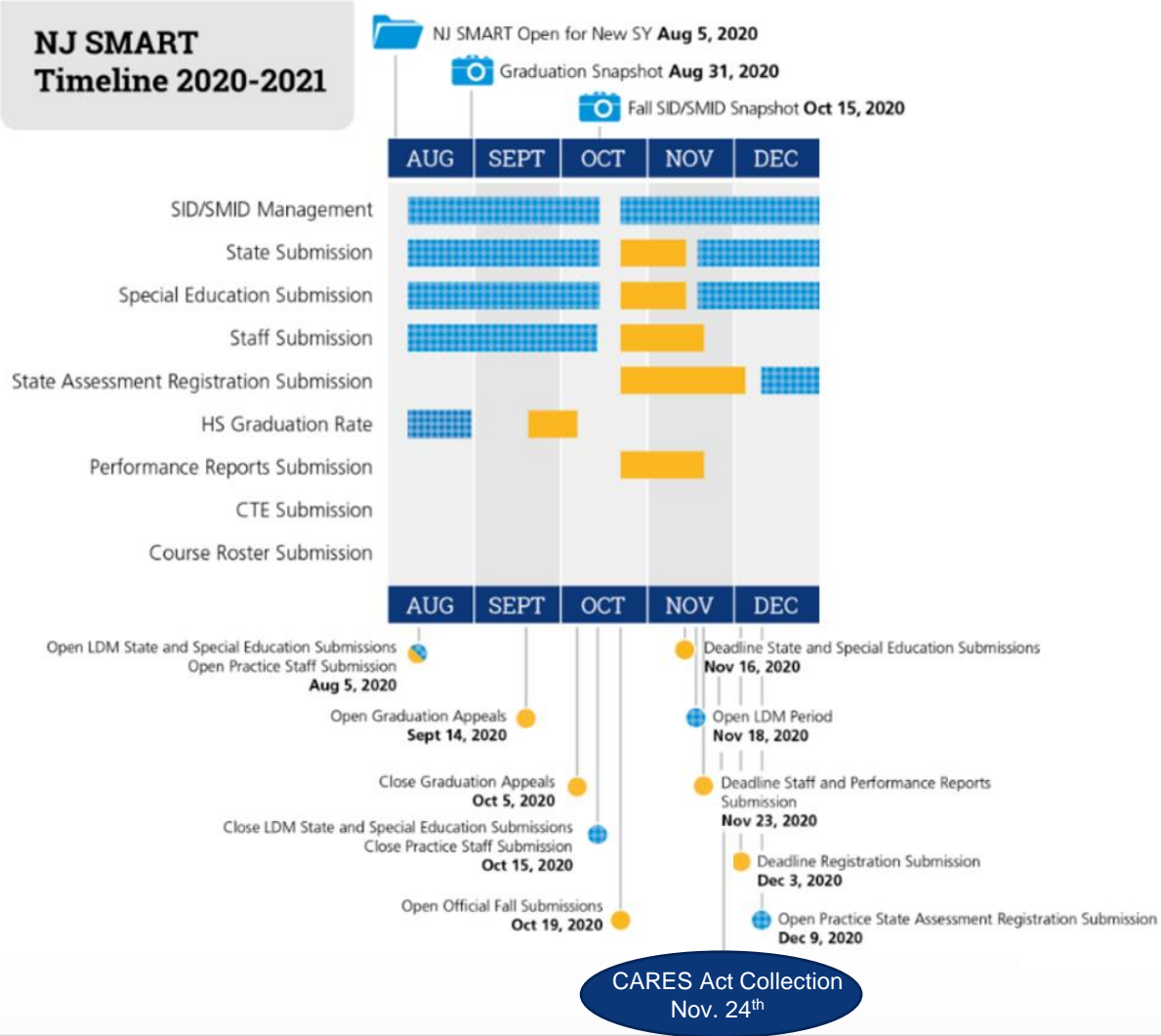

# How is this data used?

This data will be used for federal reporting purposes.

This data is federally mandated to support reporting requirements for ESSER (Education Stabilization Fund Elementary and Secondary School Emergency Relief Fund) as authorized under the CARES Act (The Coronavirus Aid, Relief, and Economic Security Act).



# Getting Started

It is **mandatory** for all districts to download the SID Management Student Data Handbook for review of definitions, additional notes, and common errors.

## NJ SMART Resources & Trainings

### About this Site

The NJ SMART Resources & Trainings website links users to important information occurring within NJ SMART, including downloadable resources and webinar and on demand trainings available to assist you throughout the data submission process.

### Maintaining Security and Policy Compliance when working with Student and Staff Data

Users are reminded that NJ SMART is a secure data transfer and reporting site. By accessing this site you acknowledge that the work completed within NJ SMART is subject to the rules and requirements of the Family Educational Rights and Privacy Act (FERPA) regarding the confidentiality of student records and the Federal Privacy Act regarding employee records collected by Federal agencies. Any suspected unauthorized use of this site should be reported immediately to NJ SMART at 800-254-0295.

### Questions and Assistance

Questions about NJ SMART can be directed to the NJ SMART Help Desk by calling (800) 254-0295 or e-mailing [NJSMART@pcgus.com](mailto:NJSMART@pcgus.com).

### Overview

### Background

### eLearning Videos & Webinars

### Documents for Download

## SID Management

- [NJ SMART SID Management Student Data Handbook v7.0](#) Updated 10/19/20
- [NJ SMART SID Management FAQ](#) \*Updated 8/5/20
- [NJ SMART Reporting Responsibilities](#) \*Updated 3/12/20
- [SID Management Training \(Online Webinar\)](#) \*Updated 8/5/20
- [SID Management Seal of Biliteracy Training \(Online Webinar\)](#) \*Updated 2/4/20
- [SID Management Template A](#) \*Updated 10/19/20
- [SID Management Template B](#) \*Updated 10/19/20
- [NJ SMART SID Chronic Absenteeism Click by Click](#) \*Updated 8/26/20
- [NJ SMART SID Management and Graduation Guide](#) \*Updated 8/5/20
- [Unresolved Click-by-Click Guide](#) \*Updated 12/20/19



# Reporting Remote and Hybrid Learning in NJ SMART

## New Data Elements:

- StudentLearningEnvironment
- RemoteDaysInMembership
- RemoteDaysPresent
- CARESActFunds
- SPESubmissionOfAssignments
- SPEParticipationInAssessments
- SPEOnlineLearningPlatforms
- SPECoachingOrCheckIn
- SPEElectronicCommunication
- SPERemoteLearningHelpLine
- SPESynchronousOnlineClass
- SPEOther
- StudentDeviceOwner
- StudentDeviceType
- StudentInternetConnectivity





# SID Management

The new data fields for CARES Act will be collected in SID Management.  
This data can be added via:

- File upload
- Add a Student
- Editing records through the All Student Records page



For more information on how to upload to a NJ SMART collection:  
[New User Training.](#)



**Questions?**



# Which Students are Reported?

This information should be reported for all students that were in attendance at any point during the 2020-2021 SY.

- The data should reflect the student's status and remote learning information as of 10/15
- For students that entered the district after 10/15, please report the most current information
  - Students with a District Entry Date after 10/15 will be excluded from the Fall collection
- CARES Act data is not required for Non-public and preschool referral students



# NJ SMART Reporting Responsibilities

The data collected in NJ SMART will follow the NJ SMART Reporting Responsibilities.

- You should enter the new data fields for students that are your LEA's reporting responsibility, including students that are placed in an out-of-district placement by the LEA
  - LEAs should work with the student's placement to obtain this information to report to SID Management for the November 24<sup>th</sup> collection
- The new data elements are not required for nonpublic students and preschool referral students.



# Student Learning Environment

The chosen method for delivering instruction to the student.

- 1 = Fulltime on premises
- 2 = Hybrid (partial in person on premises/partial remote instruction)
- 3 = Fulltime remote—district choice
- 4 = Fulltime remote—parental or guardian choice

If a student received both in person and remote learning between the start of the school year and October 15th, Hybrid should be reported.



# Data Element: CARES Act Funds

An indication how your LEA used CARES ACT funds.

- This information should be answered at the district level to indicate if your LEA used CARES Act funds to develop, initiate, and/or implement remote learning and/or provide home internet access for students



# SPE Data Elements

An indication of the methods used to document **student participation and engagement** during remote learning.

- SPESubmissionOfAssignments
  - SPEParticipationInAssessments
  - SPEOnlineLearningPlatforms
  - SPECoachingOrCheckIn
  - SPEElectronicCommunication
  - SPERemoteLearningHelpLine
  - SPESynchronousOnlineClass
  - SPEOther
- 
- These fields are required for all students, except Non-Public and preschool referral students. If the students did not receive remote learning, a value of “N” should be entered
  - For students that received remote learning, please rely on your district policies for determining student participation and engagement in periods of remote learning



# Remote Attendance

Remote Days in Membership and Remote Days Present will be used to capture remote attendance data.

- Remote Days In Membership and Remote Days Present should reflect each student's remote learning attendance from the first day of school through October 15<sup>th</sup> for the Fall collection
- Students with a District Entry Date of October 16<sup>th</sup> and after will be excluded from the Fall collection
  - Please report the most recent data for these students in preparation for the EOY collection.







**Questions?**

**Any questions before  
we review FAQs?**

# Inactive Students

How should the new data fields be reported for inactive students? Do we need to activate inactive student records to add this information?

- Summer withdrawals and graduates who were appropriately captured as inactive on the Fall Snapshot should now be **removed** from SID Management via a full file upload that excludes these inactive records
  - You do not need to report the new data fields for these students
- Students that attended the 2020-2021 SY at any point, but have exited the district, need to be maintained as inactive records in SID Management for the EOY Snapshot
  - You should report the information for the new data fields for these students as of their School Exit Date



# Shared-time students

How should the CARES Act data elements be reported for shared-time vocational students?

- For shared time vocational school students that are only attending half of the day, the CARES Act data elements should reflect the student's learning environment at the non-vocational school they are attending the rest of the day
- The student's attendance should be calculated as half days to reflect the actual attendance of the student



# Hybrid Students

For students who are in a hybrid learning environment, should Student Internet Connectivity, Student Device Owner, and Student Device Type reflect the internet connection/device they use while at home or while on-site at the school?

- You should report data based on the student's remote learning environment, not the student's learning environment on school premises



# Scenario 1

Student received instruction remotely from the start of the school year through 10/15 because the parent is not comfortable sending the child to school to receive in person instruction.

- Student Learning Environment
  - 4 = Fulltime remote – parental or guardian choice
- Student was absent for one day:
  - Remote Days in Membership = 30
  - Remote Days Present = 29
- LEA used CARES Act funds to develop, initiate and/or implement remote learning for the student, and provide home internet access
  - CARES Act Funds = 1
- The district is using Participation in Assessments and Electronic Communication to document student participation and engagement
  - SPE Electronic Communication and SPE Participation in Assessments = Y, other SPE data elements = N
- School provided internet access through mobile hotspots with paid data plans
  - Student Internet Connectivity = 2
- Student uses a school provided Chromebook
  - Student Device Owner = 3
  - Student Device Type = 1



# Scenario 2

Student has been on a hybrid learning schedule since the first day of school through 10/15 where the student attends two days a week in person, three days a week remote.

- Student Learning Environment
  - 2= Hybrid
- Student has been marked absent for 2 days, one remote day, one in-person day
  - Remote Days in Membership = 18
  - Remote Days Present = 17
- LEA used CARES Act funds to develop, initiate and/or implement remote learning for the student, but not to provide home internet access
  - CARES Act Funds = 2
- The district is using Submission of Assignment, Electronic Communication, and Participation in Assessments to document student participation and engagement
  - SPE Submission of Assignments, SPE Electronic Communication, SPE Participation in Assessments = Y, other SPE data elements = N
- Student used personal internet access during remote learning
  - Student Internet Connectivity = 1
- Student uses a school provided laptop
  - Student Device Owner = 3
  - Student Device Type = 1



# Scenario 3

Student received instruction entirely in person at school from the start of the school year through 10/15.

- Student Learning Environment
  - 1 = Fulltime on premises
- Student has been marked absent for 3 days
  - Remote Days in Membership = 0
  - Remote Days Present = 0
- The LEA did not use CARES Act funds to either develop, initiate and/or implement remote learning for its students nor did it use CARES Act funds to provide home internet access for some students.
  - CARES Act Funds = 4
- SPE data elements
  - Each field should have a value of N
- Student Internet Connectivity
  - Leave blank
- Student Device Owner
  - 7 = None
- Student Device Type
  - 5 = None



# Scenario 4

Student began the school year receiving in person instruction at school for two weeks. The district moved to remote instruction for two weeks because the school had to close due to COVID-19 exposure. After two remote weeks, the student returned to in person instruction.

- Student Learning Environment
  - 2= Hybrid
- Student has not been absent and learned remotely for 10 days:
  - Remote Days in Membership = 10
  - Remote Days Present = 10
- The LEA used CARES Act funds to provide home internet access for some students, but DID NOT use the funds to develop, initiate and/or implement remote learning.
  - CARES Act Funds = 3
- Submission of Assignments was used to determine student participation and engagement during remote learning
  - SPE Submission of Assignments = Y, other SPE data elements = N
- Student used school provided internet access through a district-managed wireless network
  - Student Internet Connectivity = 5
- Student uses personal laptop
  - Student Device Owner = 1, Student Device Type = 1





# Fall Collection vs. Snapshot

## Is the November 24<sup>th</sup> Fall Collection an official Snapshot?

- No, the collection that will be taken November 24<sup>th</sup> is not an official Snapshot
  - This collection will not be reported to NJQSAC
  - Errors that are related to the new data fields collected for CARES Act should be resolved by November 24<sup>th</sup>
- The data collected at the End of Year (June 30, 2021) will be reported to NJQSAC. All reporting errors at that time will be associated with the sending district





# Questions?

**Any questions before we  
adjourn today's training?**

# Available Resources

## NJ SMART Helpdesk



1-800-254-0295  
[njsmart@pcgus.com](mailto:njsmart@pcgus.com)

## Resources & Trainings



[NJ SMART Resources & Trainings](#)



**Solutions that Matter**

